

Delovi za grejače  
Materijal: Cu, Čelik  
Zaštita: Ni

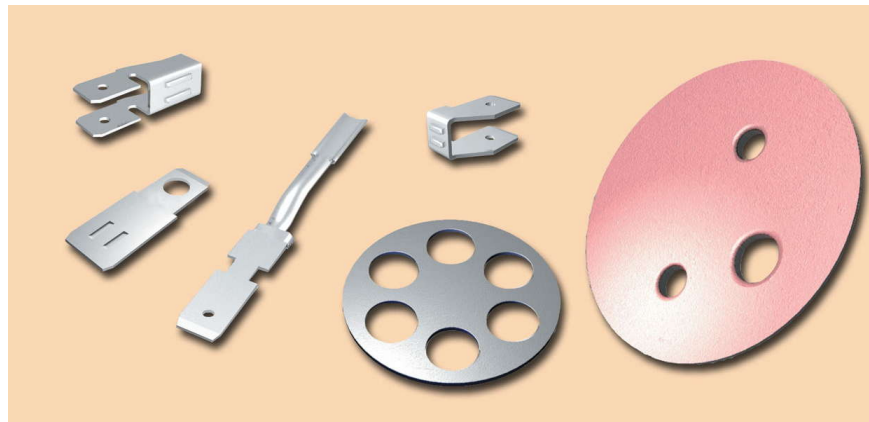

<p>Kontakt za kvarcne grejače Kod 5037</p>	<p>Dupli spojni jezičak Kod 5034</p>	<p>Spojni jezičak Kod 5035</p>
<p>Materijal: Čelik Zaštita: Ni</p>	<p>Materijal: Čelik Zaštita: Ni</p>	<p>Materijal: Čelik Zaštita: Ni</p>
<p>Dupli spojni jezičak Kod 50341</p>	<p>Nosač grejača malog bojlera Kod 7102</p>	<p>Odstojnik za grejač Kod 7101</p>
<p>Materijal: Čelik Zaštita: Ni</p>	<p>Materijal: Cu</p>	<p>Materijal: Čelik Zaštita: Ni</p>

Zaptivači i podloške

Materijal: Bakar, Aluminijum, Čelik, Mesing, Bronza

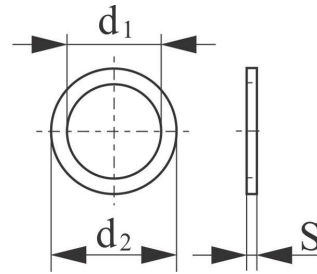
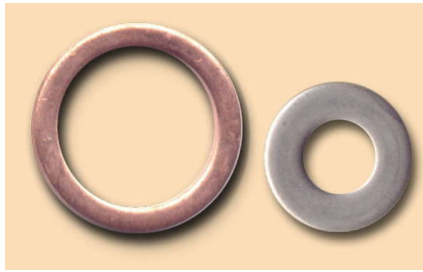





JUS M.C4.500A (DIN 7603A)

Nestandardne veličine

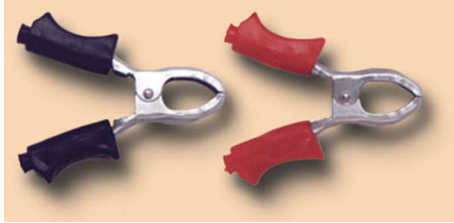
Kod	Nazivna mera mm-mm	d <sub>1</sub> mm	d <sub>2</sub> mm	S mm	Kod	Nazivna mera mm-mm	d <sub>1</sub> mm	d <sub>2</sub> mm	S mm
1001	4 - 8	4.2	7.8	1.0	1051	6 - 17	6.2	16.8	JUS M.B2.011
1002	5 - 9	5.2	8.8		1052	7 - 22	7.2	21.8	
1003	6 - 10	6.2	9.8		1053	8 - 18	8.2	17.8	
1004	6 - 12	6.2	11.8		1054	9 - 13	9.2	12.8	
1005	8 - 12	8.2	11.8		1055	9 - 17	9.2	16.8	
1006	8 - 14	8.2	13.8		1056	9 - 20	9.2	19.8	
1007	10 - 14	10.2	13.8		1057	10 - 17	10.2	16.8	
10097	10 - 15	10.2	17.9		1058	10 - 20	10.2	19.8	
1008	10 - 16	10.2	15.8		1059	10 - 21	10.2	20.8	
1009	12 - 16	12.2	15.8		1060	11 - 18	11.2	17.8	
1010	12 - 18	12.2	17.8	1061	11 - 22	11.2	21.8		
1065	12 - 19	12.2	18.8	1062	12 - 15	12.2	14.8		
1011	14 - 18	14.2	17.8	1063	12 - 20	12.2	19.8		
1012	14 - 20	14.2	19.8	1064	12 - 26	12.2	25.8		
1013	16 - 20	16.2	19.8	1066	13 - 18	13.2	17.8		
1014	16 - 22	16.2	21.8	1067	13 - 20	13.2	19.8		
10171	17 - 23	17.2	22.8	1068	14 - 24	14.2	23.5		
1015	18 - 22	18.2	21.8	1069	15 - 24	15.2	23.8		
1016	18 - 24	18.2	23.8	1070	16 - 30	16.2	29.8		
1017	20 - 24	20.2	23.8	1072	18 - 26	18.2	25.8		
1018	20 - 26	20.2	25.8	1073	18 - 28	18.2	27.8		
1075	21 - 26	21.2	25.8	1074	21 - 24	21.2	23.8		
1019	22 - 27	22.2	26.8	1076	21 - 30	21.5	28.8		
1020	22 - 29	22.2	28.8	1077	22 - 32	22.3	31.8		
1021	24 - 30	24.3	29.8	1079	27 - 36	27.3	35.8		
1022	24 - 32	24.3	31.8	1081	41 - 58	41.0	58.8		
1023	26 - 32	26.3	31.8	1082	2.5 - 10	2.7	9.8		
1024	26 - 34	26.3	33.8	1083	3 - 7	3.2	7.0		
1078	27 - 32	27.3	31.8	1084	6 - 12	6.2	12.5		
1025	28 - 34	28.3	33.8	1085	6.5 - 17	6.8	16.8		
1026	28 - 36	28.3	35.8	1086	8 - 20	8.0	19.8		
1027	30 - 36	30.3	35.8	1087	11 - 17	11.2	16.8		
1028	30 - 38	30.3	37.8	1088	11.5 - 18	11.8	17.8		
1029	32 - 38	32.3	37.8	1089	12 - 17	12.5	16.8		
1030	32 - 40	32.3	39.8	1090	12.5 - 19	12.7	18.8		

1080	33 – 39	33.3	38.8		1091	14 - 22	14.5	21.8	
1031	34 – 41	35.3	40.8		1092	15 – 26	15.2	25.8	
1032	38 – 44	38.3	43.8		1093	15 – 29	15.2	28.8	
1033	38 – 46	38.3	45.8		1094	17 – 27	17.2	26.8	
1034	40 – 47	40.3	46.8		1095	20 – 27	20.2	26.8	
1035	42 – 49	42.3	48.8		1096	25 – 32	25.2	31.8	
1036	48 - 55	48.3	54.8		1098	13 - 24	13.2	23.8	
Pakovanje po 100 komada.									
Bakarni zaptivači se isporučuju omekšani (termički obrađeni).									

Kontakt klešta	
<p>Laboratorijska klešta</p> <p>Kod 0051</p>	
<p>Papagaj klešta</p> <p>Kod 0052</p>	
<p>Krokodil klešta</p> <p>Kod 0053</p>	
<p>Univerzal klešta</p> <p>Kod 0054</p>	
<p>Metalna klešta</p> <p>Kod 0055</p>	
<p>PVC klešta</p> <p>Kod 0056</p>	

Kablovi za  
startovanje

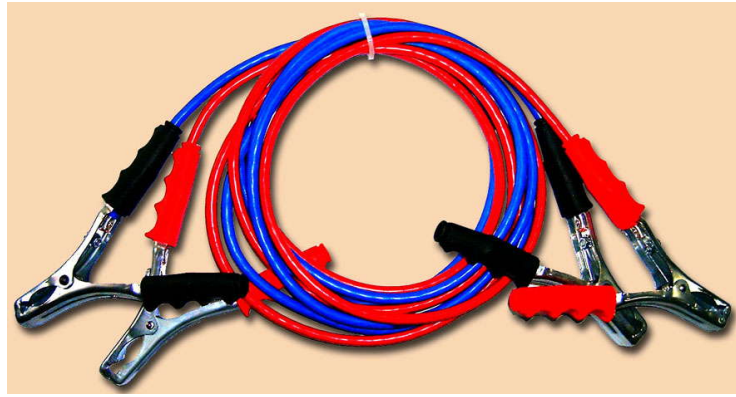

Kod	Presek provodnika mm <sup>2</sup>	Dužina m
0070	6	3
0071	10	3
0077	10	4
0072	16	3
0075	16	4
0076	16	5
0073	25	4
0074	25	5

Nosai trafoa		
Kod	Naziv	
0401	NT-75 M1	
04011	NT-75 M2	
0402	NT-84	
0403	NT-96 M1	
04031	NT-96 M2	
0404	NT-108	
0405	NT-120	
0406	NT-150	
0411	NTP-48x17	
0412	NTP-48x20.5	
0413	NTP-48x21.5	
0414	NTP-48x26	

Razno

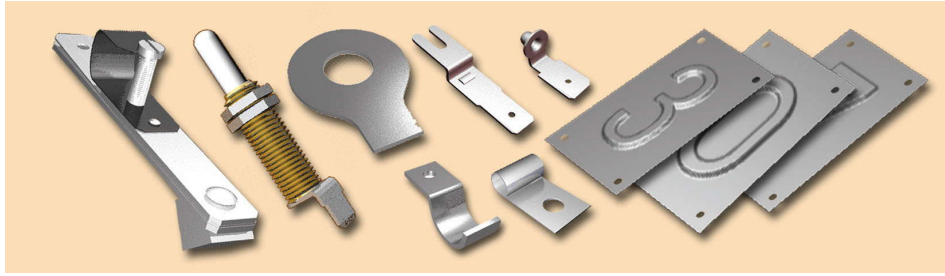

Kontakt za kondenzatore  
Kod 5032

Materijal: CuZn  
Zaštita: Cu, Sn

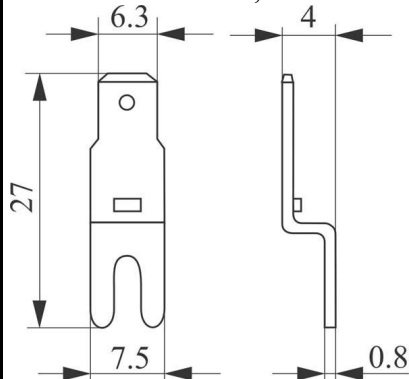

Kontakt-zakovica  
Kod 5033

Materijal: CuZn  
Zaštita: Cu, Sn

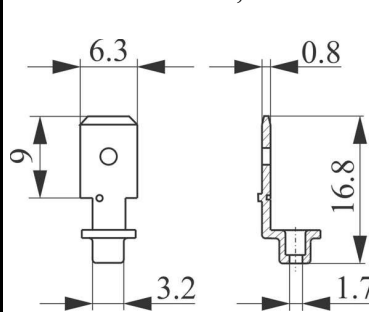

Prekidač za alarmne uređaje  
Kod 5601

Materijal: CuZn  
Zaštita: Sn

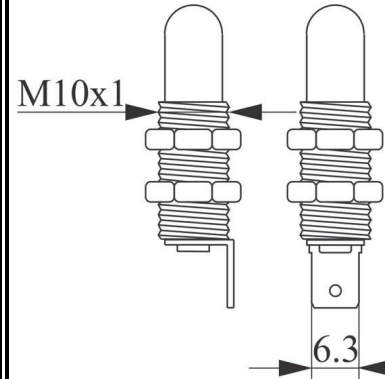

Kontakt za dizalice  
Kod 7108

Zaštita: Sn

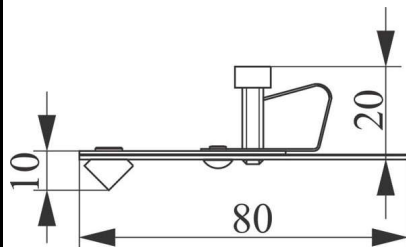

Kontakt zastavica za četkicu  
(grafitnu)

Materijal: CuZn  
Zaštita: Sn

Kod	Presek Provod. mm <sup>2</sup>	d <sub>1</sub> mm	d <sub>2</sub> mm	A mm	L mm
5631	0.5-1.5	1.8	3.2	8	12
5632	1.5-2.5	2.3	5.3	11.5	18.4
5633	4-6	3.5	6.5	12	21.5

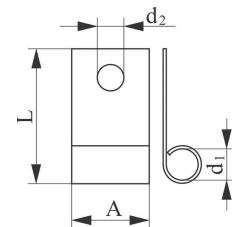

Držač kabla  
Kod 5611

Materijal: Čelik  
Zaštita: Zn

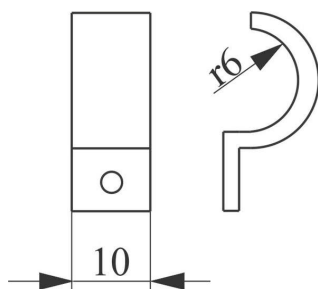

Aluminijumske cifre 0-9  
Kod 5621

Materijal: Al

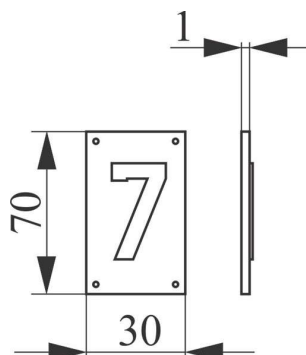

Osigurač za navrtku M12  
Kod 1310

Materijal: Čelik  
Zaštita: Zn

